

### COMMON

- Added accessories can affect a motorcycle's stability, performance and safe riding speed.

### FRONT BRACKET

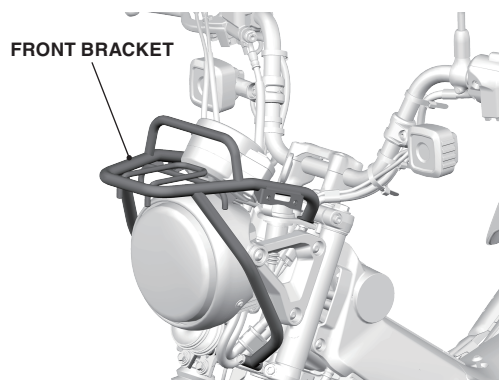

- The weight of the cargo must not exceed the following maximum loading capacity:  
**1.0 kg (2.2 lb)**
- Check the accessory mounts frequently and retighten if necessary.
- Clean this accessory with a soft cloth soaked with a solution of mild detergent and water. Then wipe with a clean cloth soaked with water to clean dirt and detergent. Finally wipe dry with a soft, clean cloth.

### CENTER BRACKET

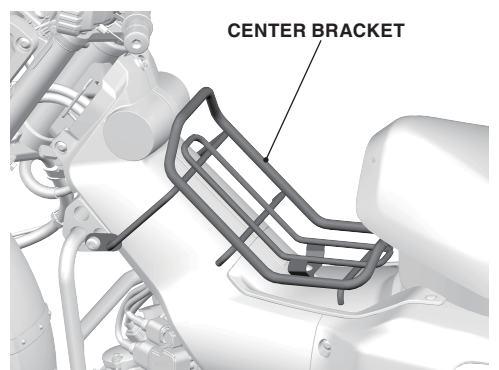

- The weight of the cargo must not exceed the following maximum loading capacity:  
**1.0 kg (2.2 lb)**
- Check the accessory mounts frequently and retighten if necessary.
- Clean this accessory with a soft cloth soaked with a solution of mild detergent and water. Then wipe with a clean cloth soaked with water to clean dirt and detergent. Finally wipe dry with a soft, clean cloth.

### SADDLEBAG SUPPORT

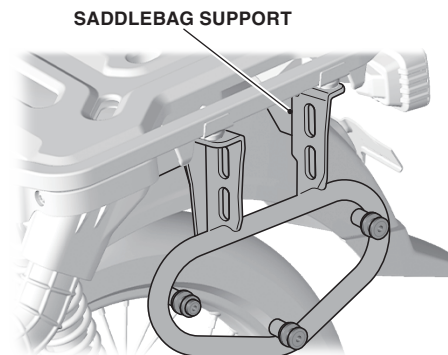

- Check the accessory mounts frequently and retighten if necessary.
- Clean this accessory with a soft cloth soaked with a solution of mild detergent and water. Then wipe with a clean cloth soaked with water to clean dirt and detergent. Finally wipe dry with a soft, clean cloth.

### WIND SHIELD

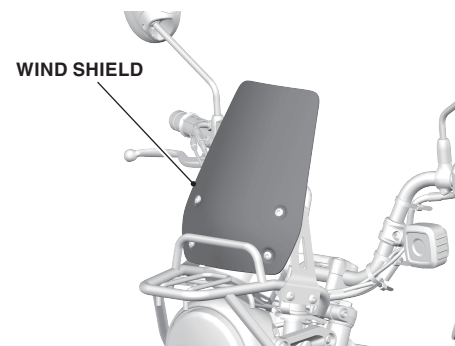

- Handle this accessory with care. It can be damaged when it is bent excessively or is subject to strong shock or impact.
- Park the motorcycle in the shade when it is to be left unattended in the summer for an extended period of time with a body cover placed over it.
- Failure to observe this precaution can cause this accessory to be deformed due to heat built up under the body cover.
- Select a firm, level surface when you park the motorcycle. Also bear in mind that strong wind can cause the motorcycle to topple to the ground.
- Check the accessory mounts frequently and retighten if necessary.
- When this accessory becomes dirty, rinse it thoroughly with cool water to remove loose dirt, then wipe with a clean cloth or sponge. Do not use a brush to clean this accessory as it may scratch the surface.
- Never use organic solvents such as gasoline, thinner or benzene to clean this accessory. Also do not use acid or alkaline cleaners.
- Wipe up spilled brake fluid at once as it may damage the plastic surface.

### SADDLEBAG

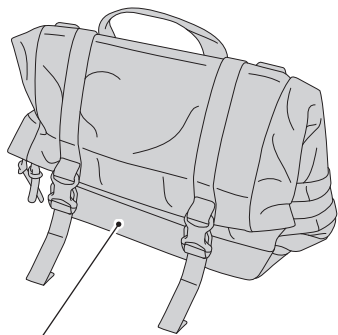

SADDLEBAG

- The weight of the cargo must not exceed the following maximum loading capacity:

**saddlebag                      2.0 kg (4.4 lb)**

- Check that saddle bag and strap do not interfere with the motorcycle body. Pay special attention to hot parts and rotating parts.
- Check that the fastener is closed and the strap is tightened before riding.
- The inner bag is made of a material that is resistant to water from the outside, but is not completely waterproof due to its structure. There is a possibility of internal condensation or inundation due to the influence of heat while riding, running in the rain for a long time, or motorcycle washing.
- Due to the nature of the inner bag, do not store dangerous items, sharp objects, protrusions, or valuables.
- Check the accessory mounts frequently.
- Clean this accessory with a soft cloth soaked with a solution of mild detergent and water or a cleaner.
- If this accessory becomes completely wet (water has soaked through the material), remove this accessory and allow it to air dried at room temperature. Never dry this accessory in a dryer, in front of a heater, or near a fireplace.

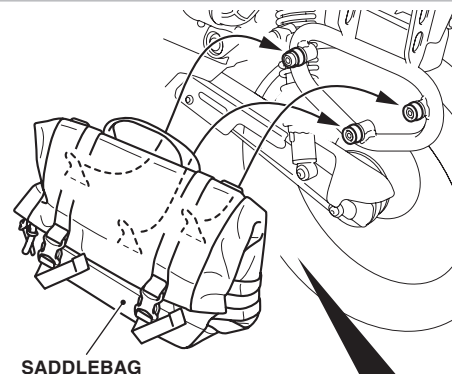

SADDLEBAG

#### HOW TO INSTALL THE SADDLEBAG

1. Install the saddlebag as shown.
  - Be sure that saddlebag is installed securely.

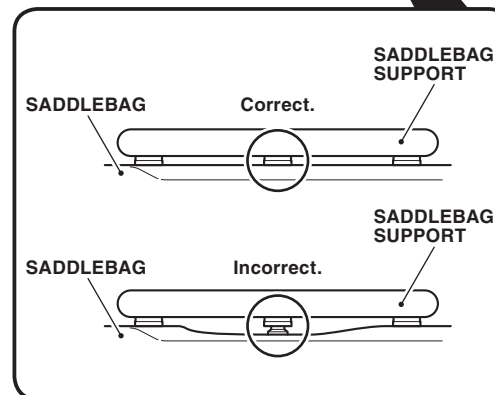

#### HOW TO REMOVE THE SADDLEBAG

1. Lower the lever as shown and remove the saddlebag.

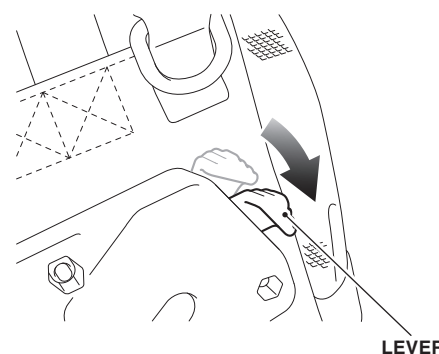

LEVER

### SHOULDER STRAP

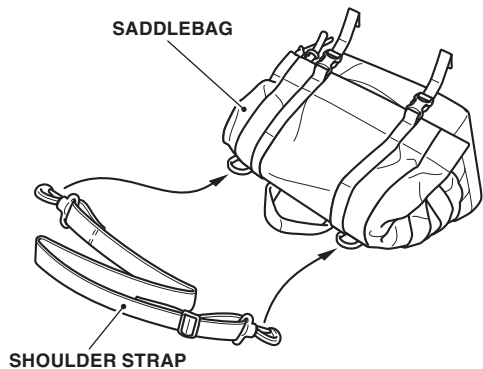

#### HOW TO USE THE SHOULDER STRAP

1. Hook the shoulder strap as shown.
  - Always store the shoulder strap when not in use.
  - Use the shoulder strap when carrying the saddlebag.

### FOLDING CHANGE PEDAL

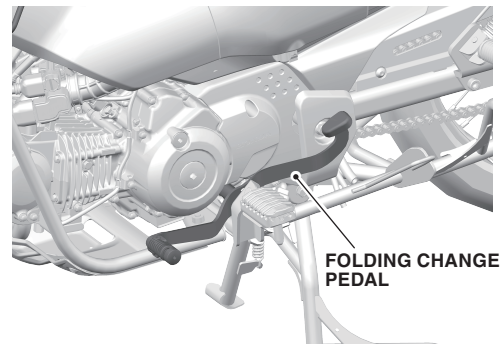

- Check the accessory mounts frequently.
- Clean this accessory with a soft cloth soaked with a solution of mild detergent and water. Then wipe with a clean cloth soaked with water to clean dirt and detergent. Finally wipe dry with a soft, clean cloth.

### RALLY STEP

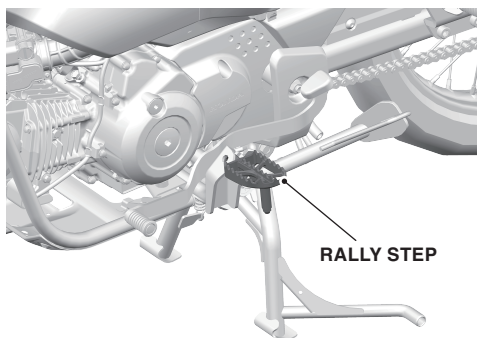

- Check the accessory mounts.
- Clean this accessory with a soft cloth soaked with a solution of mild detergent and water. Then wipe with a clean cloth soaked with water to clean dirt and detergent. Finally wipe dry with a soft, clean cloth.

### GRIP HEATER

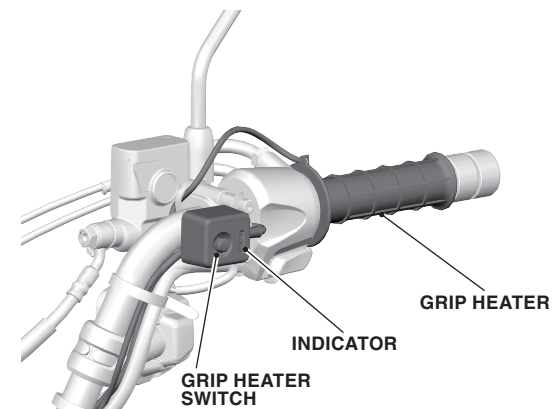

### FOLDING BRAKE PEDAL

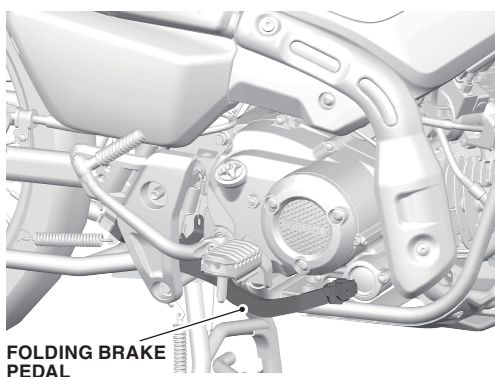

- Check the accessory mounts.
- Clean this accessory with a soft cloth soaked with a solution of mild detergent and water. Then wipe with a clean cloth soaked with water to clean dirt and detergent. Finally wipe dry with a soft, clean cloth.

- The grip heater warms up the right and left grips of the handlebar for comfortable riding on a cold day.
- The grip heater switch is located on the right handlebar pipe. To operate, adjust the grip heater switch with the engine started.

- Adjust the temperature by repeatedly pressing the grip heater switch. The temperature can be set five levels.
- Do not leave the grip heater in the high position for a long time on a warm day. Wear gloves to protect your hands from the grip heaters.
- Do not use the grip heater with the engine at idle for a long time. It may result in a low (or dead) battery.

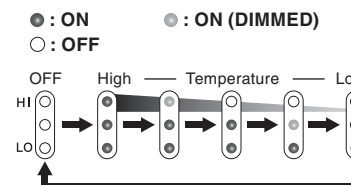

### TOP BOX

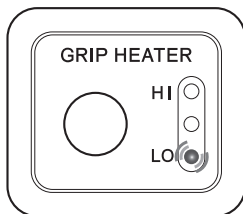

- INDICATOR OFF
- INDICATOR BLINKING

- If an indicator blinks, the battery is probably low. If the indicator continues to blink after riding for a while, charge or replace the battery.
  - When you are making a temporary stop or riding at low speed, the battery voltage level may go down. This can turn off the grip heater automatically. The heater then resumes its operation when the battery voltage level recovers after riding for a while.
- If you find any other cases of abnormalities, see your dealer.

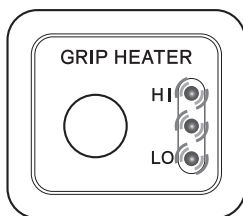

- INDICATOR OFF
- INDICATOR BLINKING

- If all three indicators blink, turn the ignition switch to the OFF position and then turn it back to the ON position.
- If indicators continue to blink, or if you find other abnormalities with the indicators, see your dealer.

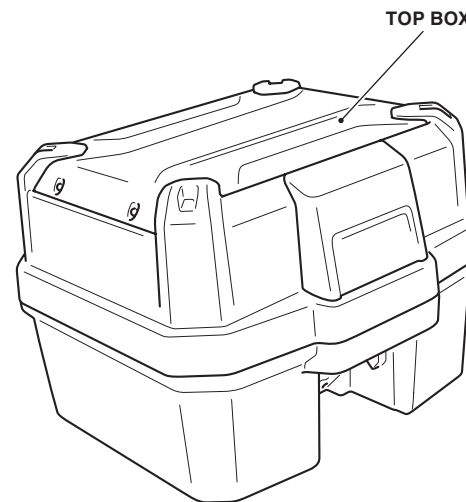

#### ⚠ CAUTION

To prevent burns, allow the engine, exhaust system, radiator, etc., to cool before installing the accessory.

- The weight of the cargo must not exceed the following maximum loading capacity:  
**Cargo weight in top box: 6.0 kg (13.2 lb)**

- Do not store valuables or easily breakable items in the top box.
- Don't place a heavy object on the opened lid or apply an excessive force from the top of opened lid.
- Be sure that the top box is installed securely before riding.
- The top box is not perfectly watertight, and water may enter when washing the motorcycle, or when it rains.
- Check the accessory mounts frequently.
- Clean this accessory with a soft cloth soaked with a solution of mild detergent and water. Then wipe with a clean cloth soaked with water to clean dirt and detergent. Finally wipe dry with a soft, clean cloth.

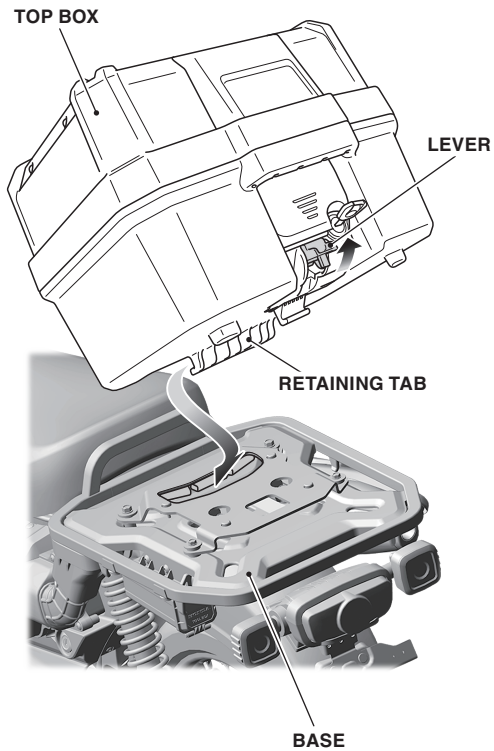

### HOW TO INSTALL THE TOP BOX

**NOTE:**  
 • The key must be turned clockwise before installing the top box.

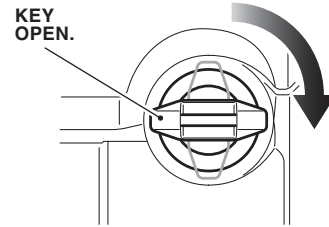

1. Insert the retaining tabs of the top box into the base with the lever in the raised position as shown.

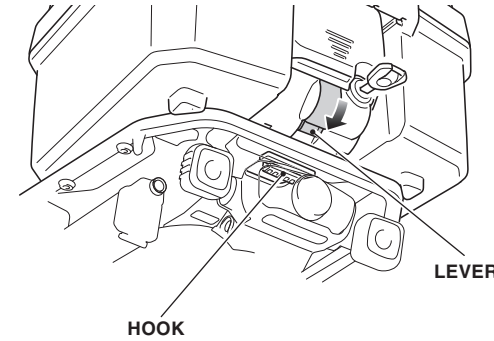

3. Secure the hook by pressing the lever down as shown.

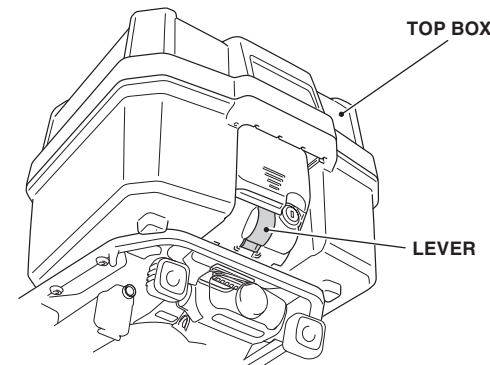
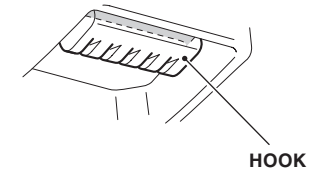

4. Lock the top box by turning the key as shown.

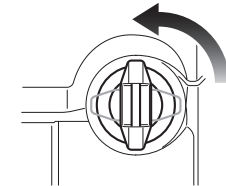

5. Remove the key. Be sure that lid and hook cannot be released and the top box is installed securely.

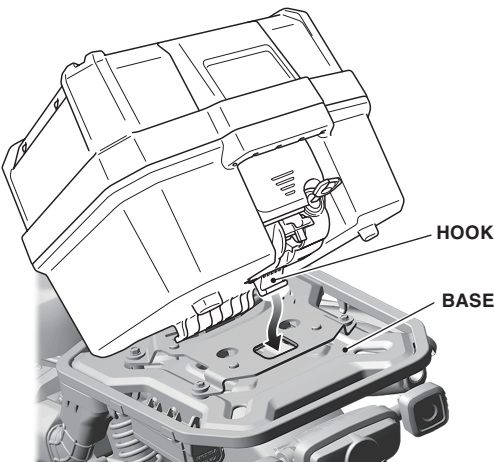

2. Position the hook of the lock assembly on the base as shown.

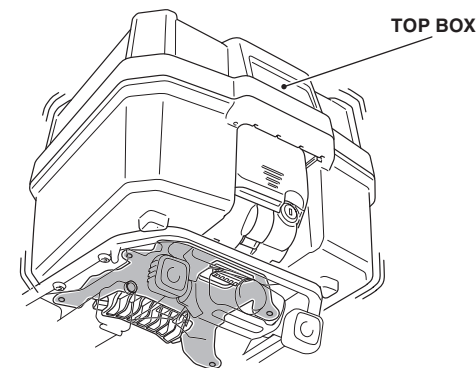
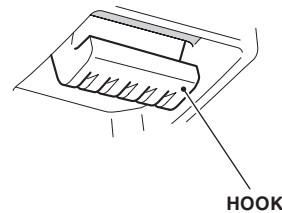

7. Check that the top box is installed securely by swinging the top box taking care not to fall the motorcycle down.

• The top box can come off during riding unless it is mounted securely.



### HOW TO REMOVE THE TOP BOX

1. Remove the top box in the reverse order of installation.

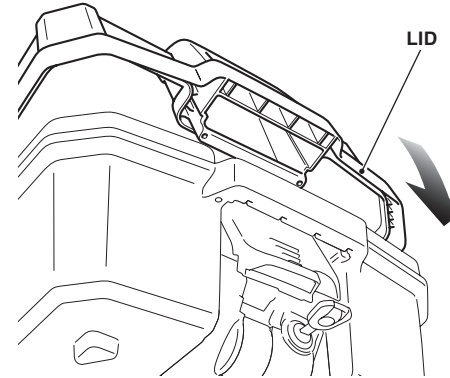

### HOW TO CLOSE THE TOP BOX

1. Confirm that the key position is as shown.

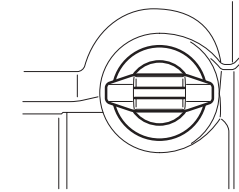

2. Close the lid.

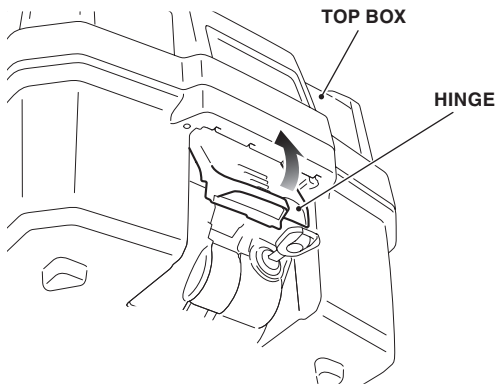

### HOW TO OPEN THE TOP BOX

1. Insert the key and release the lock by turning the key as shown.

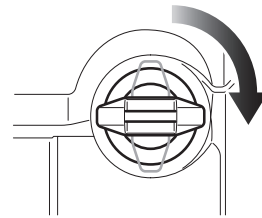

2. Pull the hinge up as shown.

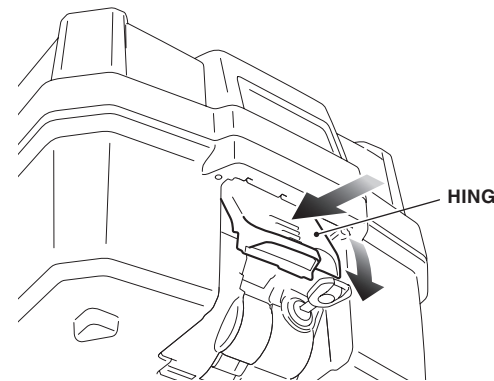

3. Holding the upper part of the hinge, push the hinge down.
  - Be careful not to have the stored item pinched when the top box is closed.
4. Lock the top box by turning the key as shown.

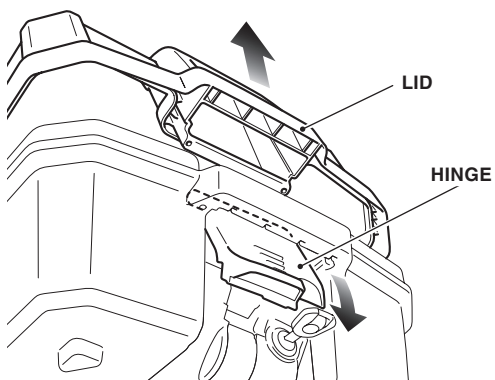
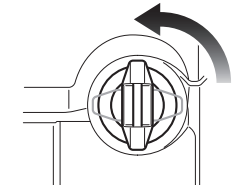

3. Raising the upper part of hinge, move the hinge down as shown and open the lid.

5. Remove the key.
  - Make sure the lid is locked down securely.

### SAFETY INFORMATION

The following sentences show the label meaning. Some labels warn you of potential hazards that could cause serious injury. Others provide important safety information. Read this information carefully and don't remove the label.

If a label comes off or becomes hard to read, contact your Honda dealer for a replacement.

There is a specific symbol on each label. The meanings of each symbol and label are as follows.



Read the use and care information in installation instructions or genuine accessory user's guide carefully. Read the **LOAD LIMITS AND GUIDELINES**, and **TYRES** sections in owner's manual.

#### **DANGER (with RED background)**

You **WILL** be **KILLED** or **SERIOUSLY HURT** if you don't follow instructions.



#### **WARNING (with ORANGE background)**

You **CAN** be **KILLED** or **SERIOUSLY HURT** if you don't follow instructions.

#### **CAUTION (with YELLOW background)**

You **CAN** be **HURT** if you don't follow instructions.

Refer to this information for the meanings of the symbols shown on the accessory.

#### CARRIER WARNING LABEL



#### TOP BOX WARNING LABEL

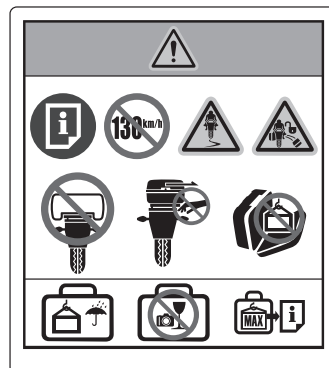

#### SCREEN WARNING LABEL

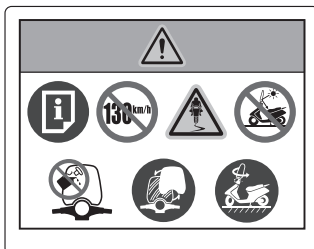

Never ride a motorcycle equipped with accessories and a cargo at speeds above 130 km/h (80 mph).



When driving with the motorcycle, all locks of all bags must be securely locked. Panniers or top box may fall off if not locked properly to the carrier or stay. Check for secure locking before riding.



Added accessories and cargo can reduce a motorcycle's stability, performance and safe riding speed. A motorcycle's stability is influenced by an improper loading, worn or under-inflated tyres, the overall motorcycle condition and environmental conditions.



When the carrier base is used as a rear carrier without mounting the top box, load the cargo on the carrier base in such a manner that the ability of the carrier base to slide is not impaired.



Do not park the motorcycle with the sun shining on the backside of the unit; the reflection may damage the motorcycle parts.



Do not insert your fingers or your hand into the bracket installation part at the bottom of the top box. Your fingers may get caught between top box and bracket.



Never use organic solvents such as gasoline, thinner and benzene to clean this accessory. Also do not use acid or alkaline cleaners to clean.



Heavy cargo placed on the opened lid can damage the pannier or top box and the lid.



Replace the windshield if clear vision is obstructed.



Entry of water is possible when the vehicle is washed etc. Please be careful when placing important objects into the box. Also be careful with breakable and valuable items. Do not leave valuable items in the bags.



Select a firm, level surface when you park the motorcycle. Also bear in mind that strong wind can cause the motorcycle to fall to the ground.



Regarding the maximum loading capacity. Read the use and care information carefully in each of the accessory installation instructions or genuine accessory user's guide.